



NEW

Plastic Modular Belt Series

- > **uni RTB M1**
- > **uni RTB M2**

Pitch 50.8 mm (2.00 in.)



uni RTB - State of The Art in Roller Top Modular Belts

The new uni RTB belt is the most flexible and reliable handling solution for your goods.

Numerous variation options in roller positioning makes uni RTB the smartest straight running modular belt.

The Pinless Snap Link® enables easy assembling and provides product reliability.

uni RTB – will be the Number One Belt in the following Industries/ Applications:

Tyre and rubber industries:

- Collector belt of finished tires from vulcanizing/curing presses
- Final finish tire handling
- Sorting application
- Merging application
- 90-180 degree turning
- Tyre accumulation
- Semiproducts handling
- Rubber tape slitting equipment

Material handling applications

uni RTB – Product Features and Operational Benefits:

- High efficiency with elimination of jams, line stoppages, and product damage
- Simultaneous handling of many product sizes without controls or manual adjustments.
- Facilitated roller maintenance
- Pinless Snap Link® concept for easy assembling and product reliability
- Roller height above belt surface three and six mm (M1 and M2)
- Flexible roller positioning
Rollers in six different positions: 0°, 30°, 60°, 90°, 120° and 150°
- M2 rollers for active conveying
- No rollers blocking even with sticky rubber

Standard Selection

uni RTB M1

uni RTB M2
Dimension for rollers

 uni RTB M1: 17.9 mm (0.70 in.)
 uni RTB M2: 23.9 mm (0.94 in.)

- Straight running
- 50.8 mm (2.00 in.)
- See Belt catalog
- 65.0 mm (2.56 in.)
- See page 5
- See Belt catalog

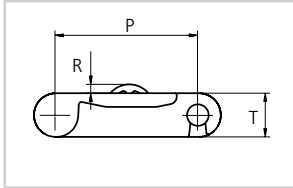
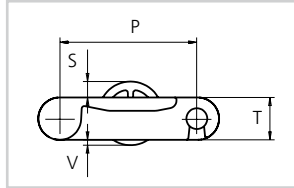
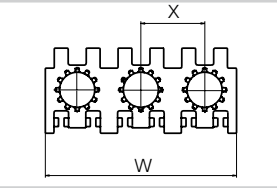
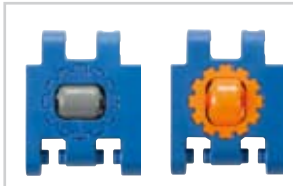
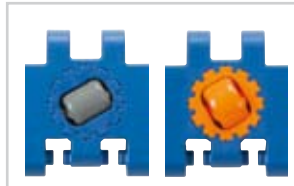
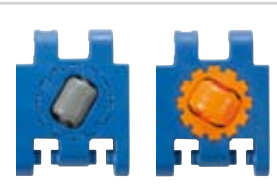
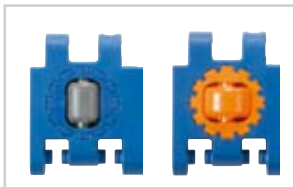
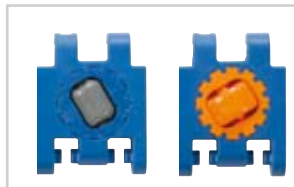
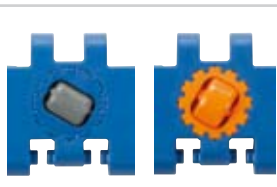
Dimensional Sketches

uni RTB M1

uni RTB M2

uni RTB M1 | uni RTB M2
Roller position

uni RTB M1 | uni RTB M2
000°

uni RTB M1 | uni RTB M2
030°

uni RTB M1 | uni RTB M2
060°

uni RTB M1 | uni RTB M2
090°

uni RTB M1 | uni RTB M2
120°

uni RTB M1 | uni RTB M2
150°

Dimensions

	mm	in.
P	50.8	2.00
T	16.0	0.63
R	3.0	0.12
S	6.0	0.24
V	2.0	0.08
W	152.8	6.00
X	50.8	2.00

uni RTB M1

The rollers are only extending on one side of the belt - the top. Accumulation rollers provide less friction between the belt and the conveyed product and ensure the best possible sideways loading of the belt.

uni RTB M2

The rollers are only extending on two sides of the belt - the top and the bot-

tom. When the belt rollers are rotating, the conveyed products will move faster than the belt. When the belt rollers do not rotate, the conveyed product will travel at belt speed.

Mounting positions

0° = Rollers rotate in travel direction.

30° = Roller pins angled counter clockwise 30° (move products to the left).

60° = Roller pins angled counter clockwise 60° (move products to the left).

90° = Roller pins rotate perpendicularly to the travel direction.

120° = Roller pins angled counter clockwise 120° (move products to the right).

150° = Roller pins angled counter clockwise 150° (move products to the right).

Standard Materials and Colors

Type	Standard materials and colors	Standard roller materials and colors	Standard cover plate materials and colors	Standard pin for rollers
uni RTB M1	POM-S B	POM-NL G	POM-NL B	SS304
uni RTB M2	POM-S B	POM-NL O	POM-NL O	SS304

Standard Bricklaid Belt Widths

mm	in	mm	in	mm	in	mm	in
153	6.0	509	20.0	865	34.1	1222	48.1
204	8.0	560	22.0	916	36.1	1273	50.1
255	10.0	611	24.0	967	38.1	1323	52.1
305	12.0	662	26.1	1018	40.1	1374	54.1
356	14.0	713	28.1	1069	42.1	1425	56.1
407	16.0	764	30.1	1120	44.1	1476	58.1
458	18.0	814	32.1	1171	46.1	1527	60.1

On above belt width values, the belt width tolerance on standard materials is +0/-0.4% at 23°C/73°F

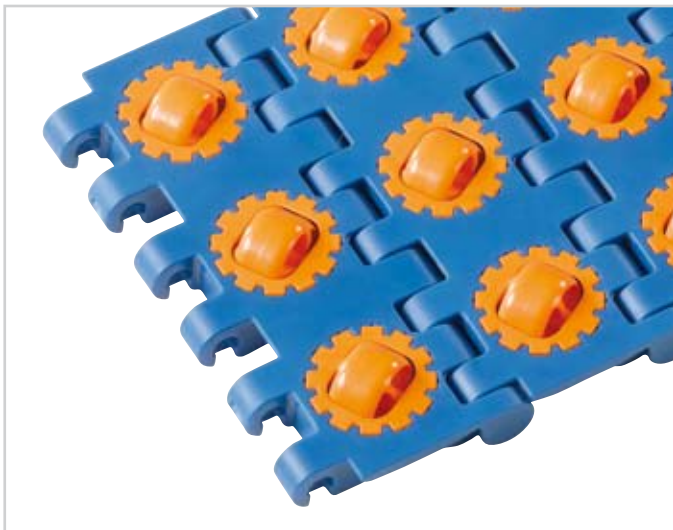
uni RTB Single Link®

uni RTB Single Link® is available in the following standard width:

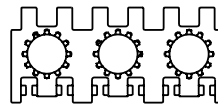

K600 (152.8 mm (6.00 in.))

Belt Weights

Belt material	POM	
	kg/m ²	lb/ft ²
uni RTB M1 uni RTB M2	20.1	4.12

Permissible Tensile Strength

Belt material	POM	
	N/m	lbf/ft
uni RTB M1 uni RTB M2	27500	1884

Max. Load per Roller

Belt material	Max. permissible static load		Max. permissible dynamic load	
	N	lbf	N	lbf
uni RTB M1	3000	674	100	23
uni RTB M2	2000	449	100	23

Standard Sprockets

No. of teeth	Pitch diameter		Overall diameter		Hub diameter		Bore		Reference no. plastic
	mm	in.	mm	in.	mm	in.	mm	in.	
6	101.6	4.00	99.5	3.92	65.0	2.56	∅18.0/40.0*	∅0.71/1.57*	183PA6MPBH06111N00
							sq 38.1	sq 1.50	183PA6MPBH06111N00I150S
							sq 40.0	sq 1.57	183PA6MPBH06111LG00M040S
8	132.8	5.23	132.9	5.23	65.0	2.56	∅18.0/40.0*	∅0.71/1.57*	183PA6MPBH08111LG00
							sq 38.1	sq 1.50	183PA6MPBH08111LG00I150S
							sq 40.0	sq 1.57	183PA6MPBH08111N00M040S
					100.0	3.94	sq 50.8	sq 2.00	183PA6MPBH08111N00I200S
10	164.4	6.47	166.3	6.55	65.0	2.56	∅18.0/40.0*	∅0.71/1.57*	183PA6MPBH10111N00
							sq 38.1	sq 1.50	183PA6MPBH10111N00I150S
							sq 40.0	sq 1.57	183PA6MPBH10111LG00M040S
					120.0	4.72	∅40.0/70.0*	∅1.57/2.76*	183PA6MPBH10111LG01
							sq 50.8	sq 2.00	183PA6MPBH10111N00I200S
							sq 63.5	sq 2.50	183PA6MPBH10111N00I250S
sq 60.0	sq 2.36	183PA6MPBH10111LG00M060S							
12	196.3	7.73	198.6	7.82	65.0	2.56	∅18.0/40.0*	∅0.71/1.57*	183PA6MPBH12111LG02
							sq 38.1	sq 1.50	183PA6MPBH12111N00I150S
							sq 40.0	sq 1.57	183PA6MPBH12111N00M040S
					120.0	4.72	∅40.0/70.0*	1.57/2.76*	183PA6MPBH12111N01
							sq 50.8	sq 2.00	183PA6MPBH12111N00I200S
sq 60.0	sq 2.36	183PA6MPBH12111N00M060S							
16	260.4	10.25	263.8	10.04	65.0	2.56	∅18.0/40.0*	∅0.71/1.57*	183PA6MPBH16111N00
					150.0	5.91	∅40.0/70.0*	1.57/2.76*	183PA6MPBH16111N01

* Minimum/maximum round bore.

Placement of Wearstrips and Sprockets

No. of teeth	Minimum B-dimension		Wearstrip distance A	
	mm	in.	mm	in.
6	59.5	2.34	36.2	1.43
8	75.1	2.96	53.6	2.11
10	91.0	3.58	70.5	2.78
12	107.0	4.21	87.2	3.43
16	139.2	5.48	120.2	4.73

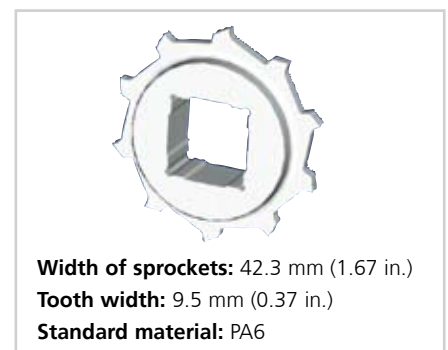
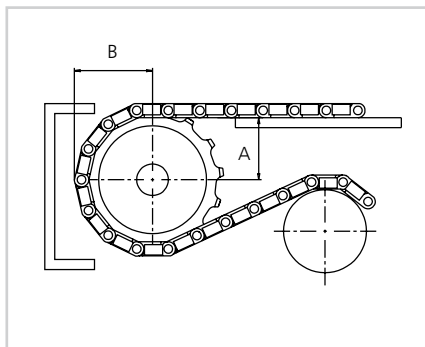

Other sprocket sizes are available upon request. Two-part sprockets are available upon request.

Max. Load per Sprocket

Belt material	POM	
	N	lbf
uni RTB M1 uni RTB M1	2000	337

Ammeraal Beltech Modular



Argentina

Bandax Argentina S.A.
tel: +54 11 4717 5151
fax: +54 11 4717 6777
e-mail: bandax@bandax.com

Australia

Heat & Control Pty. Ltd.
tel: +61 7 3877 6333
fax: +61 7 3343 8371
e-mail: uni@heatandcontrol.com.au

Australia

Renold Australia Pty. Ltd. (Chains)
tel: +61 3 9262 3333
fax: +61 3 9561 8561
e-mail: melsmg@renold.com.au

Australia

Rydell Industrial Co.
tel: +61 3 9555 7922
fax: +61 3 9553 3908
e-mail: salesvic@rydell.com.au

Austria

Ammeraal Beltech GmbH Austria
tel: +43 1292 9372
fax: +43 1292 8906
e-mail: info@ammeraalbeltech.at

Austria

Katena Stahlgelenksetten GmbH
tel: +43 1292 1071
fax: +43 1292 9762
e-mail: office@katena.at

Belarus

LTD Asboga
tel: +375 17 287 3727
fax: +375 17 285 6487
e-mail: tanja_v@unichains.ru

Belgium

Ammeraal Beltech N.V.
tel: +32 2466 0300
fax: +32 2466 4272
e-mail: salesgb@ammeraal-beltech.be

Belgium

Ketten Wulf NV
tel: +32 9243 7373
fax: +32 9221 5603
e-mail: service@ketten-wulf.be

Brazil

Sampla Belting
tel: +55 11 2144 4500
fax: +55 11 2144 4550
e-mail: sampla@sampla.com.br

Bulgaria

Alexandris Engineering LTD
tel: +35 9326 07540
fax: +35 9326 76221
e-mail: alexandris_plovdiv@alexandris.org

Canada

Ammeraal Beltech Modular, Inc.
tel: +1 610 372 1800
fax: +1 610 372 3590
e-mail: sales@unichains.com

Chile

Ammeraal Beltech Chile S.A.
tel: +56 2669 6975
fax: +56 2669 6709
e-mail: ventas@ammeraalbeltech.cl

Chile

Ducasse Comercial Ltda.
tel: +56 2696 3126
fax: +56 2698 3873
e-mail: ventas@ducasse.cl

China

AA Industrial Belting (Shanghai) Co. Ltd.
tel: +86 21 6534 4690
fax: +86 21 6548 0430
e-mail: webmaster@ammeraalbeltech.com.cn

Colombia

Oxicortes S.A.
tel: +57 4262 0323
fax: +57 4262 3912
e-mail: oxicortes@epm.net.co

Czech Republic

Ammeraal Beltech s.r.o.
tel: +420 567 563 631
fax: +420 567 330 637
e-mail: prodej@ammeraalbeltech.cz

Czech Republic

Murtfeldt Plasty s.r.o.
tel: +420 272 706 052
fax: +420 272 706 101
e-mail: info@murtfeldt.cz

Denmark

Ammeraal Beltech Modular A/S
tel: +45 7572 3100
fax: +45 7572 3348
e-mail: admin@unichains.dk

Egypt

United Trading Co.
tel: +20 224510793
fax: +20 224530255
e-mail: egyunited@yahoo.com

Estonia

Tecnobalt Eesti OÜ
tel: +372 661 3160
fax: +372 661 3165
e-mail: info@tecnobalt.ee

Ecuador

Tadeler S.A.
tel: 593 4265 1272
fax: 593 4600 5978
e-mail: tadeler@tadeler.com

Finland

Ammeraal Beltech Oy
tel: +358 207 911 400
fax: +358 207 911 450
e-mail: info@ammeraalbeltech.fi

Finland

SKS-mekaniikka OY
tel: +358 20 764 61
fax: +358 20 764 6824
e-mail: mekaniikka@sk.fi

France

Ammeraal Beltech S.A.S.
tel: +33 3 2090 3600
fax: +33 3 2032 2917
e-mail: client@ammeraalbeltech.fr

France

Ammeraal Beltech Modular A/S France
tel: + 33 3 4467 4692
fax: + 33 3 4467 4693
e-mail: france@unichains.com

Greece

George P. Alexandris S.A.
tel: +30 210 411 1841 5
fax: +30 210 411 8171
e-mail: gpalex@alexandris.gr

Germany

Ammeraal Beltech Modular GmbH
tel: +49 5971 91437 0
fax: +49 5971 91547 5
e-mail: admin@unichains.de

Hungary

Ammeraal Beltech Lörincz Ltd.
tel: +36 2342 7510
fax: +36 2342 7511
e-mail: info@ammeraalbeltech.hu

Hungary

Tech-Con Hungaria KFT
tel: +36 1412 4173
fax: +36 1412 4171
e-mail: agnes@tech-con.hu

Iceland

Bakverk-Heidsala EFT
tel: +35 4517 2220
fax: +35 4517 2221
e-mail: bakverk@bakverk.is

India

Lakhotia Beltings Private Ltd.
tel: +91 80 28364995
fax: +91 80 41170559
e-mail: lakhotiabelling@vsnl.net

Ireland

Ammeraal Beltech Modular A/S UK
tel: +44 121 559 0377
fax: +44 121 559 0373
e-mail: admin@unichains.co.uk

Israel

M. Marcus Conveyor Supply Ltd.
tel: +972 3941 5150
fax: +972 3941 5575
e-mail: m_marcus@netvision.net.il

Italy

uni-chains italia s.r.l.
tel: +39 0522 922470
fax: +39 0522 922508
e-mail: unichains@unichains.it

Japan

Nihon Unichains Co., Ltd.
tel: +81 52 209 2977
fax: +81 52 231 1102
e-mail: s-sakai@unichains.co.jp

Latvia

Peruza Ltd.
tel: +371 67248036
fax: +371 67312873
e-mail: peruza@peruza.lv

Lithuania

Technobalta UAB
tel: +370 52 602 503
fax: +370 52 653 288
e-mail: lietuva@tecnobalt.com

Luxembourg

Ammeraal Beltech S.a.r.l.
tel: +352 2648 3856
fax: +352 2648 3857
e-mail: sales@ammeraal-beltech.lu

Malaysia

Ammeraal Beltech Sdn. Bhd.
tel: +60 3 8061 8849
fax: +60 3 8061 8935
e-mail: sales.kl@ammeraalbeltech.com.my

Mexico

Linarand S.A. de C.V.
tel: +52 55 5341 8131
fax: +52 55 5341 9912
e-mail: linarand@infosel.net.mx

Netherlands

Ammeraal Beltech B.V.
tel: +31 72 575 1212
fax: +31 72 571 6455
e-mail: info@ammeraalbeltech.nl

Norway

Ammeraal Beltech Modular NO
tel: +47 2220 2699
fax: +47 7572 3348
e-mail: salesnordic@unichains.com

New Zealand

Heat & Control Ltd.
tel: +64 9274 4182
fax: +64 9274 5756
e-mail: akl-spares@heatandcontrol.co.nz

New Zealand

Renold New Zealand Ltd.
tel: +64 9828 5018
fax: +64 9828
e-mail: aksales@renold.co.nz

Poland

Derco s.p. z o o
tel: +48 22 664 3887
fax: +48 22 664 3889
e-mail: derco@derco.com.pl

Portugal

Ammeraal Beltech S.A.
tel: +351 22 947 9440
fax: +351 22 941 3081
e-mail: geral@ammeraalbeltech.pt

Portugal

Harker, Sumner S.A.
tel: +351 22 947 8090
fax: +351 22 947 8098
e-mail: accionamentos.ind@harker.pt

Russia

JV Megadrive Ltd.
tel: +375 172 873727
fax: +375 172 856487
e-mail: tanja_v@unichains.ru

Russia

O.O.O. Ammeraal
tel: +7 495 234 2357
fax: +7 495 234 8803
e-mail: ammeraal@mtu-net.ru

Singapore

Ammeraal Beltech Pte Ltd.
tel: +65 6273 9767
fax: +65 6273 5490
e-mail: sales@ammeraalbeltech.com.sg

Slovakia

Ammeraal Beltech s.r.o.
tel: +421 2 5564 8541
fax: +421 2 5564 8543
e-mail: predaj@ammeraalbeltech.sk

South Africa

uni-chains ZA
tel: +27 11 397 2116
fax: +27 11 397 2117
e-mail: unichains@mweb.co.za

South Korea

Ammeraal Beltech Co. Ltd.
tel: +82 31 448 3613 7
fax: +82 31 448 3618
e-mail: amel@ammeraalbeltech.co.kr

Spain

Ammeraal Beltech S.A.
tel: +34 961 2186 38
fax: +34 961 2186 39
e-mail: cem@ammeraalbeltech.es

Spain

CID, S.L.
tel: +34 91 507 2838
fax: +34 91 507 2773
e-mail: cid@cid.es

Sweden

Ammeraal Beltech AB
tel: +46 44 43015
fax: +46 44 43349
e-mail: info@ammeraal-beltech.se

Sweden

Ammeraal Beltech Modular SE
tel: +46 (0)42 212 480
fax: +45 7572 3348
e-mail: salesnordic@unichains.com

Switzerland

Ammeraal Beltech AG
tel: +41 55 2253 535
fax: +41 55 2253 636
e-mail: info@ammeraal-beltech.ch

Switzerland

C. Plüss & Co. AG
tel: +41 44 824 8800
fax: +41 44 824 8818
e-mail: service@pluss.com

Switzerland

Renold (Switzerland) GmbH
tel: +41 44 824 8484
fax: +41 44 824 8411
e-mail: duebendorfer@renold.com

Thailand

Ammeraal Beltech Co. Ltd
tel: +66 2902 2604
fax: +66 2902 0422
e-mail: sales@ammeraalbeltech.th.com

Turkey

Mimsan Ithalat Ihracat Konveyör
tel: +90 212 657 8946
fax: +902126510073
e-mail: bant@mimsan.com.tr

Ukraine

ABSC Ukraine Ltd.
tel: +380 563 723211
fax: +380 563 713100
e-mail: ammeraal@ukr.net

United Kingdom

Ammeraal Beltech Modular A/S UK
tel: +44 121 559 0377
fax: +44 121 559 0373
e-mail: admin@unichains.co.uk

United States

Ammeraal Beltech Modular, Inc.
tel: 610 372 1800
fax: 610 372 3590
e-mail: sales@unichains.com

Uruguay

Nevinox S.R.L
tel: 598 (2) 509 1404*
fax: 598 (2) 509 1404 Extension 26
e-mail: direccion@nevinnox.com

www.unichains.com